

CONGA

ROCKSTAR

CONGA ROCKSTAR 1700 ADVANCE ERGOWET

Aspirador vertical / Upright vacuum cleaner

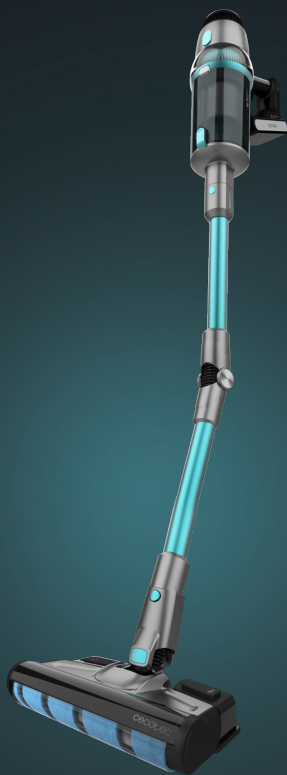

cecotec

Manual de instrucciones
Instruction manual
Manuel d'instructions
Bedienungsanleitung
Manuale di istruzioni
Manual de instruções
Handleiding
Instrukcja obsługi
Návod k použití

SAFETY INSTRUCTIONS

Read these instructions thoroughly before using the product. Keep this instruction manual for future reference or new users.

- Make sure that the mains voltage matches the voltage stated on the rating label of the appliance and that the wall outlet is grounded.
- This product is designed exclusively for household use. It is not suitable for commercial or industrial use.
- Check the power cord regularly for visible damage. If the cord is damaged, it must be replaced by the official Technical Support Service of Cecotec in order to avoid any type of danger.
- Do not use the device if it has been dropped or if there are any visible signs of damage.
- Do not try to repair the device by yourself. Contact the official Technical Support Service of Cecotec for advice.
- Never use caustic or abrasive lubricants or cleaning agents to clean the appliance.
- Do not use any accessory that has not been recommended by Cecotec, as they may cause damage.
- Do not place the appliance close to heat sources, flammable substances or wet surfaces where it could fall into water, nor allow it to come into contact with water or other liquids. Do not operate it outdoors.
- Do not use the appliance to vacuum liquids, lighted matches, cigarette ends, hot ash nor on wet surfaces.
- Do not use on concrete, tarmac or other rough surfaces.
- Remove from inside the device anything thicker than a straw as it may block the vacuuming tube.
- Stop using the device if you sense an abnormal sound or a temperature higher than usual.

- Keep the air outlet unblocked to avoid losing suction power.
- Check the vacuuming tube regularly to make sure it is not blocked.
- Take special care when using the device near stairs.
- Do not block the appliance's openings or its air flows. Keep openings free of any objects, and do not block them with clothes nor with your fingers.
- Turn off and unplug the appliance from the mains supply when it is not going to be used for a long period of time, before cleaning or repairing, before installing or uninstalling components and before removing the battery.
- WARNING: This tube has electrical connections:
- Do not use it to vacuum water;
- Do not immerse it in water to clean it;
- The tube must be checked regularly and should not be used if damaged.
- WARNING: Your device has rotating parts which may cause a risk of entrapment. Exercise extreme caution.
- Pull from the plug, not the cord, to unplug it from the outlet.
- Do not immerse the cord, plug or any part of the appliance in water or any other liquid, nor expose electrical connections to water. Make sure your hands are completely dry before handling the plug or switching on the appliance.
- This appliance can be used by children aged 8 years and above and persons with reduced physical, sensory or mental capabilities or lack of experience and knowledge if they have been given supervision or instruction concerning the use of the appliance in a safe way and understand the hazards involved. Children should not play with the appliance. Cleaning and user maintenance should not be carried out by unsupervised children.

BATTERY INSTRUCTIONS

- This device includes a lithium-ion battery.
- Do not burn or expose the battery to high temperatures, as it may explode.
- Leaks from the battery or battery cells can occur under extreme conditions. Do not touch any liquid that leaks from the battery. If the liquid gets into contact with skin, wash immediately with soap and water. If the liquid gets into the eyes, flush them immediately with clean water for a minimum of 10 minutes and seek medical attention. Wear gloves to handle the battery and dispose of it immediately in accordance with local regulations.
- Avoid contact between the battery and small metallic objects such as paper clips, coins, keys, nails or screws.
- Never modify the charger in any way.
- The battery must be removed for safe disposal.
- Keep batteries out of the reach of children when there is a risk of ingestion.
- Battery ingestion can cause burns, soft tissue perforation and death. It can cause severe burns within two hours of the ingestion.
- In case of battery ingestion please seek medical help immediately.
- **WARNING:** To recharge the battery, use only the power supply included with the device, with reference ZD24W342060EU.
- Non-rechargeable batteries should not be recharged.
- The battery's supply terminals must not be short-circuited.
- If the device is stored for a long period of time, you should remove the battery.
- The battery must be inserted in the correct position.

1. PARTS AND COMPONENTS

Fig. 1

1. Vacuuming brush head release button
2. Vacuuming tube release button
3. Dust tank bottom cover unlock button
4. Dust tank opening button and filter access
5. On/Off button
6. Power adapter
7. 2-in-1 narrow accessory for corners and furniture
8. Jalisco brush
9. Vacuuming brush head
10. Flexible vacuuming tube
11. Water tank

Fig. 2

1. Display
2. Speed dial
3. On/Off push button
4. Battery
5. Battery release button

PLEASE NOTE

The graphics in this manual are schematic representations and may not exactly match the product.

2. BEFORE USE

- This upright vacuum cleaner comes in a package designed to protect it during transport. Take the product out of the box and remove all packaging materials. Keep the original box and other packaging elements in a safe place, as this will help you prevent product damage when transporting it in the future. In case the original packaging is disposed of, make sure all packaging materials are recycled accordingly.
- Make sure all parts and components are included and in good conditions. If there is any piece missing or not in good condition, immediately contact the Technical Support Service of Cecotec.
- Fully charge the device before the first use.
- Remove the first-use tab installed in the filter.
- During the first 3 uses, it is recommended to charge the device for 12 hours between uses.
- The normal charge time is 5 hours approx. When the battery is fully charged, unplug it.

Box contents

- Conga Rockstar 1700 Advance ErgoWet
- 2-in-1 narrow accessory for corners and furniture
- Jalisco brush
- Flexible vacuuming tube
- Charger
- Water tank
- Instruction manual

3. PRODUCT ASSEMBLY

Vacuuming tube and brush head assembly

- To install the vacuuming brush head into the vacuuming tube, align both of them making sure the tab on the brush head matches the guides on the tube, and introduce one into the other until they are firmly fixed.
- To disassemble them, press the vacuuming brush head release button and pull from the vacuuming tube while firmly holding the vacuuming brush head.

Warning

When assembling these two parts, make sure the handle and the brush head are facing the same direction.

Vacuuming tube, vacuuming brush head and main body assembly

To complete the installation of the upright vacuum cleaner, hold the vacuuming tube in an upright position and insert it into the main body.

Battery assembly

Fig. 3

- Introduce the battery in the slot located in the main body following the guides. Once it is introduced, it will click into place. Once inserted, check that it is secured in position.
- To disassemble the battery, press the release button and remove the battery.

Warning

Remove the battery and store it in a safe, dry place if the device is not going to be used in a long period of time.

4. OPERATION

You can use this vacuum cleaner in two different manners:

- Handheld vacuum cleaner, attaching the accessories directly to the main body.
- Upright vacuum cleaner, using the vacuuming tube with the accessories assembled.

Using the vacuum cleaner

- Press the power button to turn the device on or off.
- Press the speed dial repeatedly to select the device's operating speed: LOW, MED, HIGH, and AUTO. The device will turn on with the LOW mode by default.
- If you select the AUTO mode, the device will automatically adjust suction power according to the concentration of dust and the type of surface.
- When operating at high speed, the device will automatically switch to medium speed in order to lengthen the battery life when the latter reaches 20%.
- The vacuuming brush head can remove dust from carpets, hard and soft floors, and tiles.
- If too many particles or fibres are vacuumed, or if a child touches the brush during operation by accident, the rotary brush stops spinning automatically in order to prevent tangles and possible damage.

Accessories

This device includes different accessories that allow cleaning different types of surfaces, objects and dirt. Some of them are suitable for the upright vacuum cleaner, and others are preferably used with the handheld one.

Jalisco brush:

Assemble this brush to the upright vacuum cleaner. This brush is especially designed for cleaning hard floors, but can be used to efficiently clean soft floors too.

2-in-1 narrow accessory for corners and furniture

Fig. 4

This accessory is preferably used with the handheld vacuum cleaner and allows cleaning furniture without damaging it and reaching less accessible dirt in corners.

Flexible vacuuming tube

Use the Flex tube to reach and vacuum dirt from the most inaccessible zones. Press the Flex button to bend the tube.

Watertank accessory

Accessory with which you can mop and scrub by simply attaching it to your vacuum cleaner.

Charge and display

- When the battery percentage is 20 % or below, the device will automatically enter the low consumption mode. It is recommended to charge the device when it reaches this percentage.
- During charging, the charge light indicator will turn on red and the display will show the current charge percentage. When the device is fully charged, the battery indicator will turn green and the display will show 100%. Fig. 5
- You can charge the battery when the battery is installed or not in the device. Connect the adapter and connect the other end to the battery, paying attention to the direction. Once it is properly connected, the charge light indicator will turn on red and will turn green once the charge is complete. Fig. 6-7

5. WATER TANK ACCESSORY

- Do not use cleaning agents. Use clean and room temperature water only. Do not use the vacuum cleaner to vacuum water.
- When the vacuum cleaner is not going to be used for a long time, please remove the water tank and empty the remaining water. Do not expose it to direct sunlight or to damp environments.

Mop installation

- Place the mop cloth on the ground with the Velcro facing upwards.
- Align the mop cloth with the velcro strips on the water tank and attach it without covering the wheels. Fig. 8

Replacing the mop

- Remove the water tank from the device.
- Use your foot to hold the accessory against the ground and pull the vacuum cleaner upwards until both parts are separated.
- Replace the mop and refill the water tank.
- Install the water tank again, insert the tank in the lower part of the vacuuming brush head and press until it is fixed.

Water emission

- When using the vacuum cleaner, make sure that the water tank cap is completely closed.
- When you are not using the vacuum cleaner, check that the water emission button and the cap are closed as the vacuum cleaner may still emit water if the water tank is full.
- To activate the water emission, the water emission push button must be pressed, and to stop the water emission, the push button must be in the original position, as shown in figure 9.

6. CLEANING AND MAINTENANCE

- Turn the appliance off, unplug it from the power socket and allow it to cool down before cleaning it.
- Use a soft, slightly dampened cloth to clean the device's surface.
- Never immerse the device in water or other liquids, do not allow liquids to enter the device.
- Do not use sponges, powder products or abrasive cleaning agents to clean the product.
- Do not leave the device in a place with direct sunlight.
- Do not leave the device in a wet place after cleaning it.
- After the brush has been used for a long time, bristles might start to tangle with hair and other particles. Clean it in order for it to operate correctly again.

Filters and tank cleaning

- To prevent the appliance from overheating and losing suction power, it is suggested to clean the filters frequently. To make the most of the suction power, it is suggested to clean the filter after every use.
- The filter's lifespan will depend on the accumulated use and the type of particles which are frequently vacuumed. It is recommended to replace the filters every 6 months.
- To remove the filters (Fig. 10):
 1. Press the dust tank opening button, marked with the word "CLEAN", and pull on the metallic handle to remove the filtering system.
 2. Once the filtering system is out, turn the metallic handle counterclockwise and you will be able to take the high-efficiency filters out.
- Vacuum and shake the filters to remove every particle and dust remain that may block them and hinder the correct circulation of air. Remember not to use the vacuum cleaner without the filters properly assembled.
- Filters cannot be washed in a washing machine nor dried with a hair dryer.
- Do not brush the high-efficiency filter.
- To empty the dust tank, press the dust tank lower cover opening button, open it, and empty it. Fig. 11

Cleaning the Jalisco brush

Fig. 12

1. Move the rotary brush release button with the finger toward the arrow and remove the cover of one of the ends of the brush.
2. Take one of the brush's ends out as shown on the image.
 - It is important to clear and clean all the residues left in the brush's rotary axes.
 - If you decide to wash the brush, you must air dry all the pieces. Assemble the parts in reverse order of disassembly so that the brush can be used again.

How to remove the battery

Press the battery release button and remove the battery as shown in figure 13. Store the battery in a plastic bag and leave it in a dry place.

Device storage

Remove the battery and store it in a safe, dry place if the device is not going to be used in a long period of time.

Maintenance indicator

If maintenance has not been carried out frequently enough, the appliance will display a full tank or clogged filter icon on the screen. Fig. 14-15

7. TROUBLESHOOTING

Problem	Possible cause	Solution
The motor does not operate	The battery does not work any longer. The metallic tubes, floor brushes, batteries or the device itself are not properly assembled.	Charge the vacuum cleaner. Make sure all parts of the device are correctly assembled.
The suction power decreased and the appliance makes a lot of noise.	The dust tank is full. Fig. 14 The filter has too much dust. Fig. 15 The electric rotary brush inlet is obstructed or the brush is blocked. Fig. 16	Clean the dirt. Clean or replace the filter. Clean the dust inside the electric rotary brush.
Insufficient operating time after charging the device. (The battery life may vary according to the room temperature).	Insufficient charge time. The battery is old.	Fully charge the battery following the instructions in this manual. Batteries are easily recycled. Go to the closest maintenance point and buy new batteries.

8. ERROR CODES

Code	Problem	Cause
E1	The device turns off and does not charge.	Short circuit
E2	The device does not charge.	The charger's voltage is below 36.3 V
E2	The device does not charge.	The charger's voltage is below 32.1 V
	The device turns off.	Low battery
E3	The device turns off and displays E3.	The motor short-circuits when the battery is low
E5	The device turns off and displays E5.	Main motor overload (second level)
E6	The device turns off and displays E6..	Main motor overload
E9	The device turns off and displays E9.	Temperature too high or low
E7	The device stops working or does not turn on and shows E7.	Battery failure (first level)
E8	The device turns off and displays E8.	NTC error (thermistor short circuit)
High-efficiency filter indicator blinks	The device stops or does not turn on. Fig. 15	High-efficiency filter not installed
The filter set logo flashes.	It works normally. Fig. 14	The dust tank or the inlet filter is blocked
The brush icon flashes	The long brush and motor stop working. Fig. 16	Blocked long brush Long brush full of hair

9. TECHNICAL SPECIFICATIONS

Product reference: 05771

Product: Rockstar 1700 Advance ErgoWet

Voltage and frequency: 100-240 V ~ 50/60 Hz

29.6 V DC 2500 mAh 74 Wh battery

Motor rated power: 630 W

Brush rated power: 50 W

Charger output: 34.2 V DC 0,6 A

Technical specifications may change without prior notification to improve product quality.

Made in China | Designed in Spain

10. DISPOSAL OF OLD ELECTRICAL APPLIANCES



This symbol indicates that, according to the applicable regulations, the product and/or battery must be disposed of separately from household waste. When this product reaches the end of its lifespan, you should dispose of the batteries/accumulators and take them to a collection point designated by the local authorities.



Consumers must contact their local authorities or retailer for information concerning the correct disposal of old appliances and/or their batteries. Compliance with the above guidelines will help protecting the environment.

11. TECHNICAL SUPPORT AND WARRANTY

Cecotec shall be liable to the end user or consumer for any lack of conformity that exists at the time of delivery of the product under the terms, conditions and deadlines established by the applicable regulations.

It is recommended that repairs be carried out by qualified personnel.

If at any moment you detect any problem with your product or have any doubt, do not hesitate to contact Cecotec official Technical Support Service at +34 96 321 07 28.

12. COPYRIGHT

The intellectual property rights over the texts in this manual belong to CECOTEC INNOVACIONES, S.L. All rights reserved. The contents of this publication may not, in whole or in part, be reproduced, stored in a retrieval system, transmitted or distributed by any means (electronic, mechanical, photocopying, recording or similar) without the prior authorization of CECOTEC INNOVACIONES, S.L.

1. PIÈCES ET COMPOSANTS

Img. 1

1. Bouton de libération de la buse d'aspiration
2. Bouton de libération du tube d'aspiration
3. Bouton d'ouverture du couvercle inférieur du réservoir de saleté
4. Bouton d'ouverture du réservoir de saleté et d'accès au filtre
5. Bouton de connexion/déconnexion
6. Adaptateur de courant

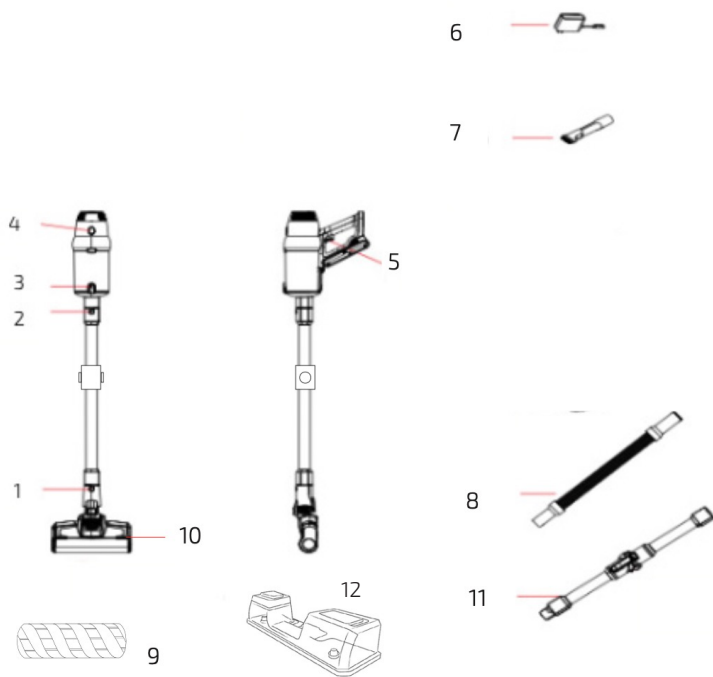

Fig./Img./Abb./Afb./ Rys./Obr. 1

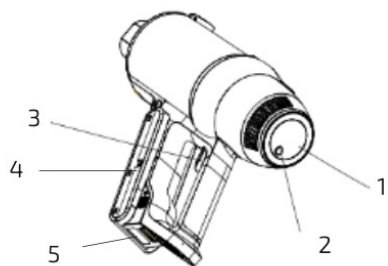

Fig./Img./Abb./Afb./ Rys./Obr. 2

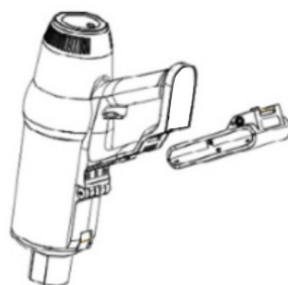

Fig./Img./Abb./Afb./ Rys./Obr. 3

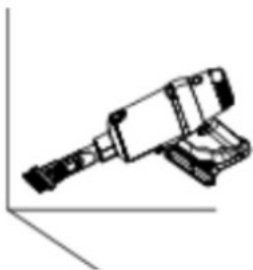

Fig./Img./Abb./Afb./ Rys./Obr. 4



Fig./Img./Abb./Afb./ Rys./Obr. 5



Fig./Img./Abb./Afb./ Rys./Obr. 6

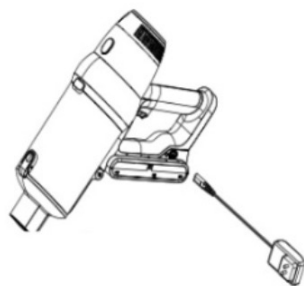

Fig./Img./Abb./Afb./ Rys./Obr. 7

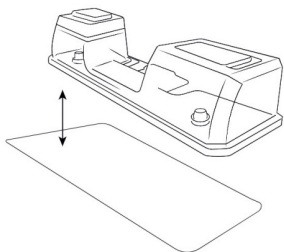

Fig./Img./Abb./Afb./ Rys./Obr. 8

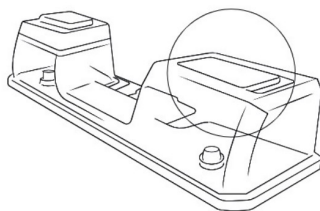

Fig./Img./Abb./Afb./ Rys./Obr. 9

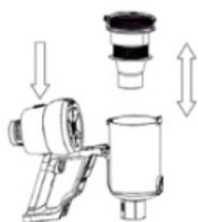

Fig./Img./Abb./Afb./ Rys./Obr. 10

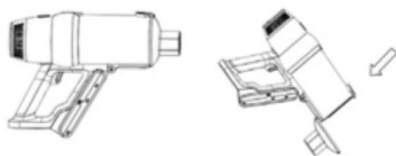

Fig./Img./Abb./Afb./ Rys./Obr. 11

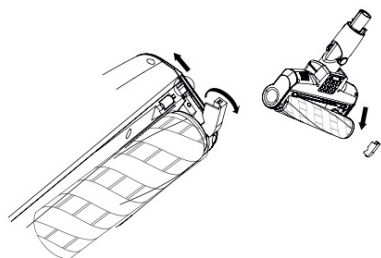

Fig./Img./Abb./Afb./ Rys./Obr. 12

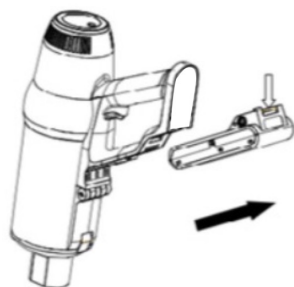

Fig./Img./Abb./Afb./ Rys./Obr. 13



Fig./Img./Abb./Afb./
Rys./Obr. 14



Fig./Img./Abb./Afb./
Rys./Obr. 15



Fig./Img./Abb./Afb./
Rys./Obr. 16

www.cecotec.es

Cecotec Innovaciones S.L.
C/ de la Pinadeta s/n, 46930
Quart de Poblet, Valencia (Spain)
YV012220510